



EUROBOT 2014 @ TU DRESDEN

Information sheet, effective 5/21/2014

*Note: To get the latest information please visit
[HTTP://TU-DRESDEN.DE/MW/DMT/EUROBOT2014](http://TU-DRESDEN.DE/MW/DMT/EUROBOT2014).*

Content

1.	Participation fee	2
2.	General map	2
3.	Contest time schedule.....	3
4.	Final's venue.....	5
5.	Accommodation.....	5
6.	Catering	6
7.	Parking.....	6
8.	Navigation.....	7
9.	Good to know	8
10.	Information about Dresden	8

PREHISTOBOT



1. Participation fee

Due to organizational reasons, there is a

**Mandatory Participation Fee of 50€ per Person,
which includes full catering for the whole event.**

See → [CATERING](#) for more details on what is included. The fee has to be paid cash when registering at the registration desk.

2. General map

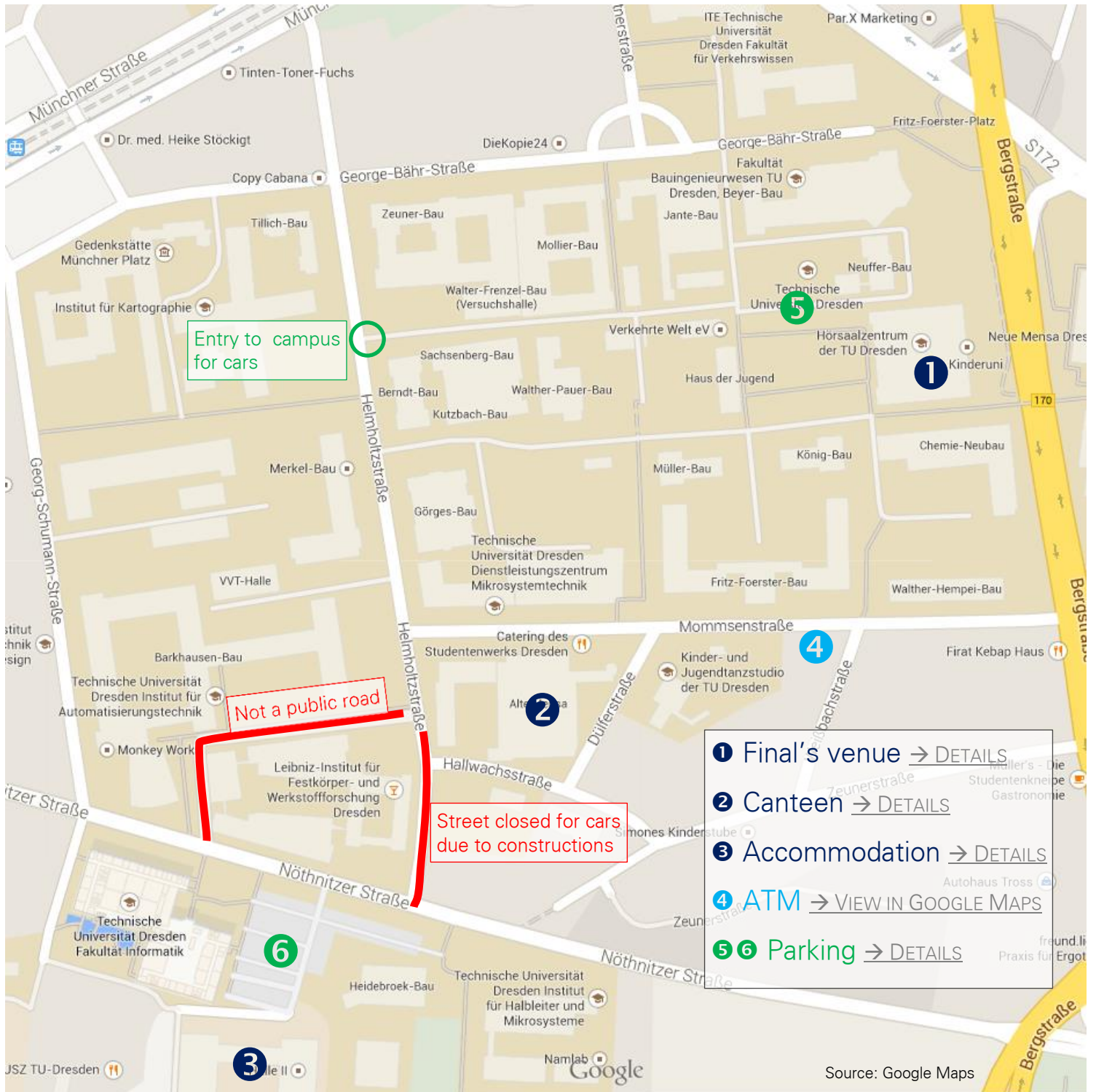

3. Contest time schedule

→ LATEST VERSION

Friday, 06/06/14				
Time	Misc	German contest	Eurobot contest	Time
13 - 14				13 - 14
14 - 15		Begin welcoming	Begin welcoming	14 - 15
15 - 16		Homologation, with precedence for german teams		15 - 16
16 - 17				16 - 17
17 - 18				17 - 18
18 - 19	Dinner			Qualification round 1
19 - 20		Homologation, with precedence for german teams	19 - 20	
19 - 20		Qualification round 2		19 - 20
20 - 21		Homologation, with precedence for german teams		20 - 21
21 - 22		End of welcoming & homologation		21 - 22

Saturday, 06/07/14				
Time	Misc	German contest	Eurobot contest	Time
7 - 8				7 - 8
8 - 9	Breakfast			8 - 9
9 - 10		Qualification round 3	Homologation	9 - 10
10 - 11		Qualification round 4		10 - 11
11 - 12		Qualification round 5		11 - 12
12 - 13	Lunch			12 - 13
13 - 14				13 - 14
14 - 15		Final	Homologation	14 - 15
15 - 16				15 - 16
16 - 17			Qualification round 1	16 - 17
17 - 18				17 - 18
18 - 19	Dinner		Homologation	18 - 19
19 - 20				19 - 20
20 - 21			Qualification round 2	20 - 21
21 - 22			End of welcoming & homologation	21 - 22

Eurobot 2014 @ TU Dresden – Information sheet

Sunday, 06/08/14			
Time	Misc	Eurobot contest	Time
7 - 8			7 - 8
8 - 9	Breakfast		8 - 9
9 - 10		Qualification round 3	9 - 10
10 - 11			10 - 11
11 - 12		Qualification round 4	11 - 12
12 - 13	Lunch		12 - 13
13 - 14			13 - 14
14 - 15		Qualification round 5	14 - 15
15 - 16			15 - 16
16 - 17			16 - 17
17 - 18		Final	17 - 18
18 - 19			18 - 19
19 - 20			19 - 20
20 - 21		Final's Party	20 - 21
21 - 22			21 - 22

Monday, 06/09/14			
Time	Misc		Time
7 - 8			7 - 8
8 - 9		Breakfast	8 - 9
9 - 10			9 - 10

4. Final's venue

→ Hörsaalzentrum TU Dresden (Auditorium Center) | *Bergstraße 64, 01062 Dresden*



→ [VIEW IN GOOGLE MAPS](#)

5. Accommodation

→ TU Dresden's gymnasia, Halle I/II | *Nöthnitzer Straße 60, 01187 Dresden*

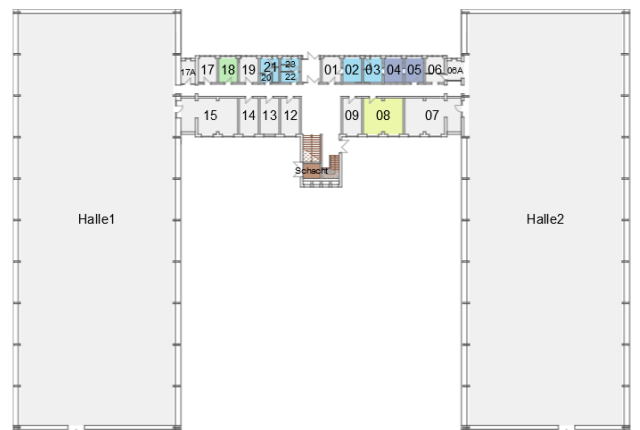

→ [VIEW IN GOOGLE MAPS](#)

Information

- Offered from Friday, 06/06/14, 6:30 p.m. to Monday 06/09/14, 12:00 p.m.
- For at most 6 persons per team
- Free of charge
- Sleeping bag and camping mat necessary
- Showers available
- Opened 24/7, access with a special voucher

Note: Accommodation can only be provided for the dates mentioned above! If you want to come earlier/leave later you have to reserve in a youth hostel/hotel yourself!

Alternative accommodation (hostels close to final's venue)

- DJH Jugendherberge "Rudi Arndt", WWW.JH-RUDIARNDT.DE
- A&O Hostel Dresden, WWW.AOHOSTELS.COM
- cityherberge Dresden, WWW.CITYHERBERGE.DE
- DJH Jugendherberge Dresden "Jugendgästehaus", WWW.JUGENDHERBERGE.DE
- Sunshine Hostel Dresden, WWW.SUNSHINE-HOSTEL.DE

There are also a lot of hotels and holiday apartments you can find with [GOOGLE](#).

6. Catering

→ TU Dresden's canteen "Alte Mensa" | *Mommsenstraße 13, 01062 Dresden*



→ [VIEW IN GOOGLE MAPS](#)

Information

- Catering will be provided as follows
 - Dinner on Friday, 06/06/14
 - Breakfast & Lunch & Dinner on Saturday, 06/07/14
 - Breakfast & Lunch & Final's Party/Barbecue on Sunday, 06/08/14
 - Breakfast on Monday, 06/09/14
- Catering is included in the participation fee of 50€ per Person.
- You have to pay cash at the registration desk when registering for the event!
- Note: Additional catering on Monday including Lunch and Dinner for 12€ per person available. Booking is only possible at the first day when registering for the event.

7. Parking

Accommodation → [VIEW IN GOOGLE MAPS](#)

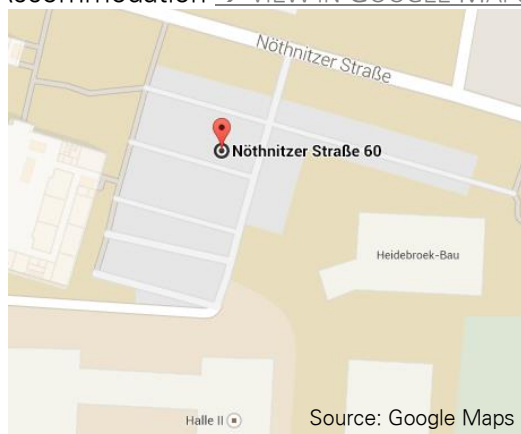

Note: Parking directly in front of the gymnasia. There is a barrier which should be opened during the whole event.

Final's venue → [VIEW IN GOOGLE MAPS](#)



Note: You can only get access via Helmholtzstraße! There is a barrier which should be opened during the whole event.

8. Navigation

How to get to finals' venue from

1. Main station (*by public transport & on foot*)

Take tram No. 3 (direction "Coschütz") or No. 8 (direction "Südvorstadt") from station "Hauptbahnhof" (main station, → [GOOGLE MAPS](#)). Leave tram at station "Nürnerberger Platz" and have a 10 min. walk according to → [WALKING ROUTE IN GOOGLE MAPS](#).

Or, take bus No.66 (direction "Freital") and leave at station "Technische Universität", directly in front of the Auditorium Center.

2. Freeway (A17) (*by car*)

Leave freeway A17 at exit No. 3 and follow → [ROUTE IN GOOGLE MAPS](#).

3. Dresden Airport (*by car or by public transport*)

By car: follow → [ROUTE IN GOOGLE MAPS](#).

Or, by public transport: take S-Bahn to Dresden main station (→ [ROUTE IN GOOGLE MAPS](#)).

4. Berlin Airport Schönefeld (*by public transport or by car*)

Take an intercity bus to Dresden main station, see WWW.BERLINLINIENBUS.DE or WWW.MEINFERNBUS.DE (Attention: bus lines often have a restriction in the amount of luggage!)

Or, take a train, for instance to Berlin main station, and take a train to Dresden main station, for booking see WWW.BAHN.COM.

Or, rent a car and follow → [ROUTE IN GOOGLE MAPS](#).

5. Berlin Airport Tegel (*by public transport or by car*)

Take an intercity bus to Dresden main station, see WWW.BERLINLINIENBUS.DE.

Or, take a train, for instance to Berlin main station, and take a train to Dresden main station, for booking see WWW.BAHN.COM.

Or, rent a car and follow → [ROUTE IN GOOGLE MAPS](#).

How to get from finals' venue to

6. Accommodation (*on foot*)

Take a walk and follow → [WALKING ROUTE IN GOOGLE MAPS](#).

7. Cantina (*on foot*)

Take a walk and follow → [WALKING ROUTE IN GOOGLE MAPS](#).

8. Inner city (*by public transport & on foot*)

Take the reverse route (see 1.) from station "Nürnberger Platz" using tram No. 3 or No. 8 or station "Technische Universität Dresden" using bus No. 66 to "Hauptbahnhof" (main station). Walk along the shopping street "Prager Straße" from main station to "Neumarkt" via "Altmarkt" following → [WALKING ROUTE IN GOOGLE MAPS](#).

Or, take tram No. 3 (direction "Wilder Mann") from station "Nürnberger Platz" (see 1.) to station "Pirnaischer Platz", take a walk following → [WALKING ROUTE IN GOOGLE MAPS](#).

How to get from accommodation to

9. Inner city (*by public transport & on foot*)

Take a walk to tram station "Münchner Platz" following → [WALKING ROUTE IN GOOGLE MAPS](#), and take tram No. 3 (direction "Wilder Mann") to "Hauptbahnhof" (main station) or "Pirnaischer Platz". Use routes according to 8.

9. Good to know

- On Sunday, June 8th and on Monday, June 9th (public holiday in Germany) all stores and supermarkets will be closed. Exceptions are listed below.

10. Information about Dresden

Tourist information

To get a brief overview over Dresden you can use [WIKIPEDIA'S ARTICLE](#). Or use Dresden's official [WEBSITE ABOUT TOURISM](#), where you can also find a list of [IMPORTANT SIGHTS](#). A list of museums and their opening hours you can find [HERE](#).

Furthermore, there are two [TOURIST INFORMATION](#) you can find at

- main station, Wiener Platz 4, 01069 Dresden, → [VIEW IN GOOGLE MAPS](#),
- "Neumarkt" near the "Frauenkirche", Neumarkt 2, 01067 Dresden, → [VIEW IN GOOGLE MAPS](#).

If you want to do sightseeing, we recommend you to visit at least

- Neumarkt and Frauenkirche
- Dresdner Schloß and Fürstenzug
- Brühlsche Terasse
- Zwinger
- Hofkirche
- Kreuzkirche
- Semperoper

Supermarkets

There are a couple of supermarkets near the final's place, → [VIEW IN GOOGLE MAPS](#) (Konsum/Frida, Netto, Lidl, Aldi, Rewe).

There is a Lidl supermarket in the main station, which is also opened on Sunday and on holidays (opening hours: Monday to Sunday 8 am to 9 pm).